



# 2hp 50 Hz Cyclonic Dust Collector Super Gorilla Owner's Manual



6\_10

## *Super* The **DUST** **GORILLA** 2hp 50 Hz



Shown with  
optional Stand.

Models may vary slightly  
in appearance.

# Thank You for Choosing an Oneida Air Systems Product!

OAS manufactures and sells dust collection equipment only. Our qualified technicians and sales staff are available 7:30am - 6:00pm EST Mon. - Thurs. and 7:30am - 5:00pm EST Fri. to answer any questions concerning OAS products and dust collection. Call for ductwork design and ductwork quotes, including system pricing and shipping cost.

**Read the entire Owner's Manual before installing or operating system!**

## Table of Contents

*Proudly Made  
in the USA*



**Page**

|        |   |    |
|--------|---|----|
| I.     | System Start-Up Information                                 | 2  |
| II.    | Commercial Configurations                                   | 3  |
| III.   | General Specifications & Fan Performance Curve              | 4  |
| IV.    | Dimensions  | 5  |
| V.     | General Assembly  | 6  |
| VI.    | General Assembly Instructions                               | 7  |
| VII.   | Bracket Assembly  | 8  |
| VIII.  | Filter Assembly   | 9  |
| IX.    | Filter Maintenance  | 10 |
| X.     | Directions for Cleaning External Filter & Clipping Dust Pan | 11 |
| XI.    | Fan / Blower Wiring Diagram                                 | 12 |
| XII.   | Troubleshooting   | 13 |
| XIII.  | Fire Hazards - <i>Read Before Installing System</i>         | 14 |
| XIV.   | Terms and Conditions  | 15 |
| XV.    | Stand Assembly  | 16 |
| XVI.   | Accessories   | 17 |
| XVII.  | Fan Motor Maintenance                                       | 18 |
| XVIII. | Optional Remote Controller Diagram                          | 19 |

# I. System Start-Up Information

---

1. Read the installation and maintenance instructions as well as the recommended safety practices in this manual
2. Install ductwork completely before operating collector:
  - A.) Seal ductwork with silicone sealant or duct tape.
  - B.) Have dust bin in place and sealed.
3. Motor is pre-wired at the factory. If magnetic starter trips circuit, check the following:
  1. Dust drum securely fastened to discharge of cone?
  2. Is ductwork installed at cyclone inlet?

## Caution

The Dust Collector & Fan / Blower is heavy! Handling and installation should always be performed by experienced and trained personnel who have experience with rotary equipment. In addition to the following instructional manual, care should be taken to ensure compliance with specific safety requirements mandated by federal, state and local codes.

## Warning

Do not operate Fan / Blower unless Fan Housing is attached to Cyclone body and Dust Drum is in place. Dust Drum and Cyclone must be in place and sealed or motor will overheat!

## Warning

If amperage is too high - shut down immediately! See Troubleshooting section.

## II. *Super* Dust Gorilla Configurations

### **Caution:**

If exhaust air is vented outside you must provide make up / return air.  
Flue gases (carbon monoxide) can be drawn into the shop from furnaces, water heaters or other appliances.

### **1. External Cartridge Filter - Silencer Included with Filter**

- Cartridge Filter Media  
99cm / 8.83 Sq. Meters  
GE H12 Certified HEPA filter media.

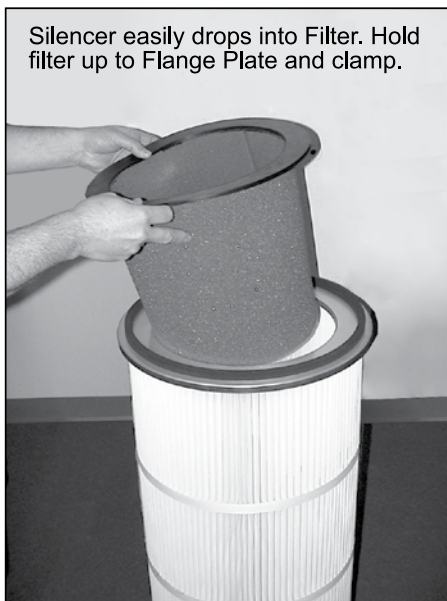

Shown with  
optional Stand.

# III. General Specifications & Fan Performance Curves

|        | Height without Dust Bin | Cyclone Diameter | Inlet Diameter | Weight without Dust Bin                        | TEFC Motors   |
|--------|-------------------------|------------------|----------------|--|---|
| 2.0 hp | 160 cm                  | 53.3 cm          | 17.8 cm        | Approx. Wt.<br>55.34 kg.<br>w/o drum or filter | Class F<br>110/220v<br>19.4 / 9.7 amps<br>1.15 Service Factor |

- Sleeve kit adds 17.8 cm (10.2 cm is minimum)
  - 132.5 liter bin is 55.9 cm dia. x 57.2 cm h / 208.2 liter bin is 55.9 cm dia. x 90.2 cm h
  - Several Filter Options Available- Galvanized steel construction
  - The collector can be hung on the wall, from the ceiling, or free standing support using the 10 ga. angle iron ring at the top of the cone.
- (See assembly instructions)

## 2hp *Super Dust Gorilla* System

- ▶ 1311 CFM @ 2" SP w/c w/ filter / 2228 M3/hr @ 485 Pascals
- ▶ Industrial TEFC 2hp motor
  - 110/220v - [17.2 Full Load / 19.6 Service Factor Amps @ 110V] [ 8.6 Full Load / 9.8 Service Factor Amps @ 220 V]
- ▶ Full 16 gauge galvanized cyclone & 11 ga. fan housing
- ▶ 17.8 cm dia. inlet / 20.3 cm rectangular outlet
- ▶ 38.1 cm dia. x 11.4 cm wide cast aluminum fan wheel  
back inclined non-sparking, non-ferrous dynamic, two-planed balanced to ISO 6.3 specifications.
- ▶ Sound 70 - 72dB @ 3 meters with Built-in Silencer and Filter
- ▶ 8.83 Sq. Meters Filter Media / Spun-Bonded

Static pressure and volume together determine a fan's performance. Several factors, such as layout of ductwork and diameter of openings, can affect a fan's performance.

## 2hp 50 Hz Export *Super Dust Gorilla* 15" Bi Wheel

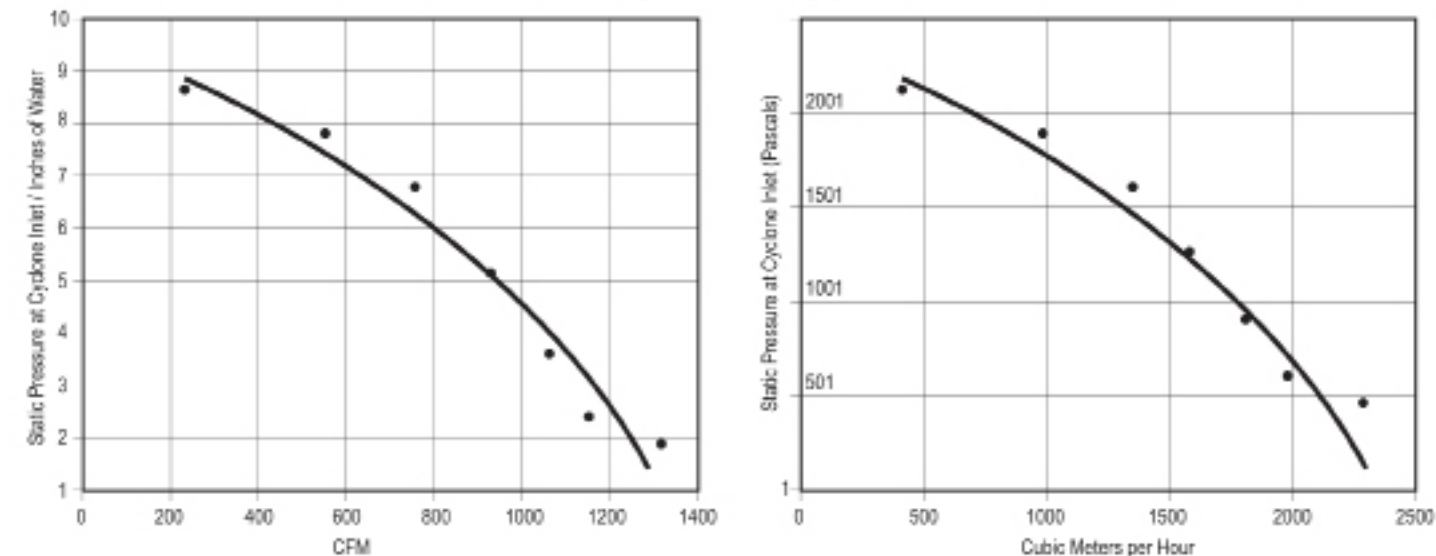

## IV. Dimensions

### *For Minimum Mounting Heights w/ 99 cm Filter*

\*Dimensions subject to slight variation in manufacturing.

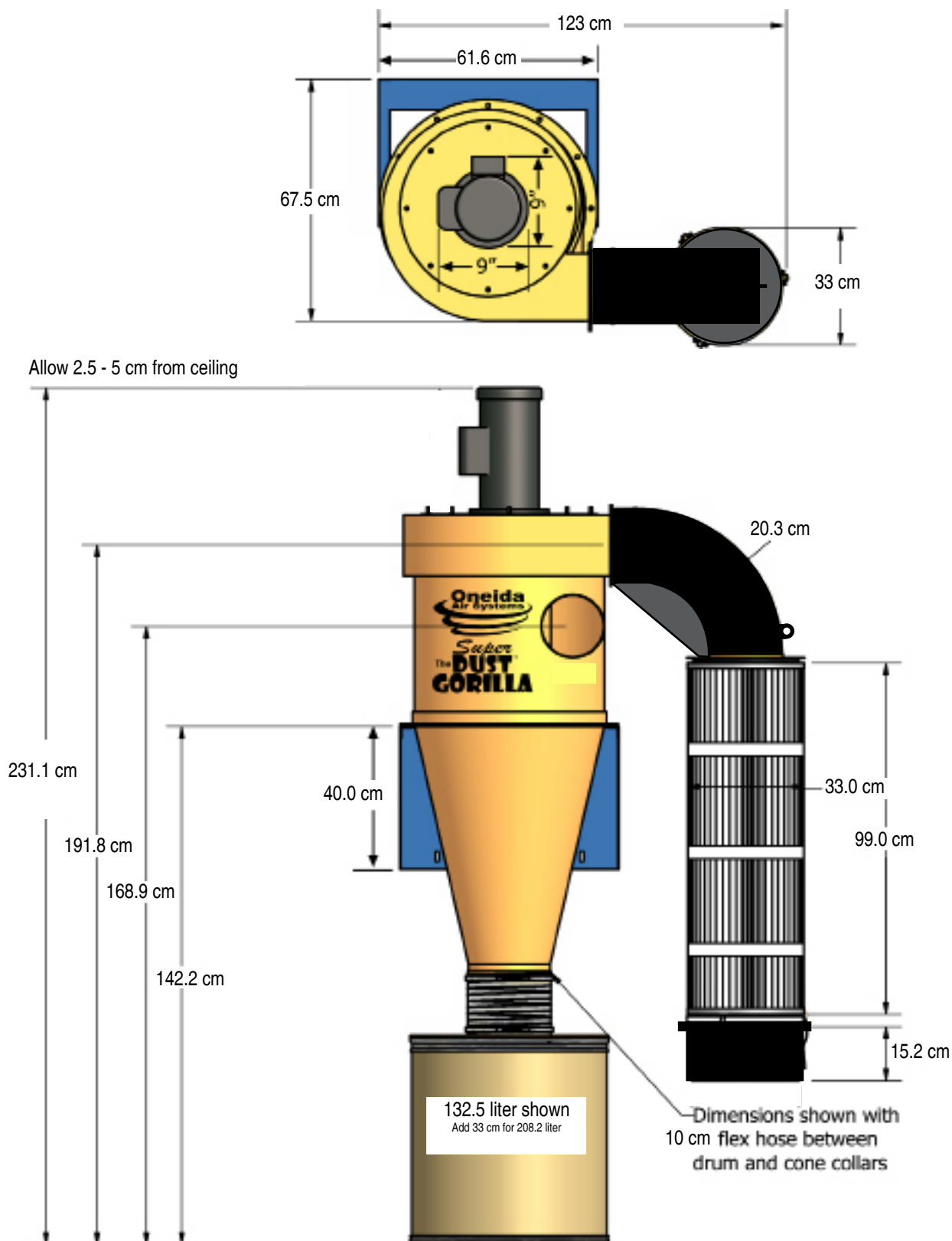



# V. General Assembly

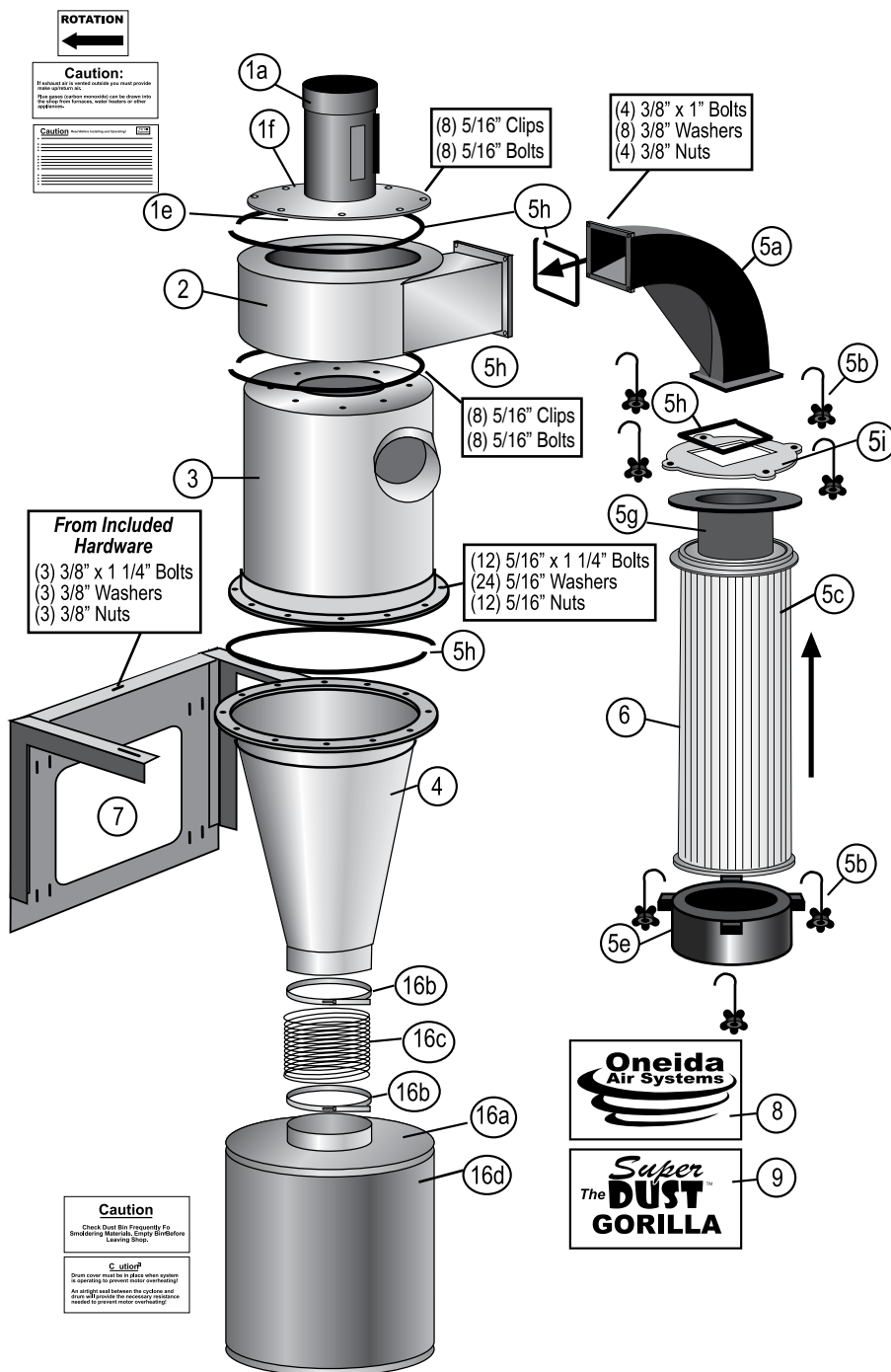

## Optional 35 & 55 Gal. Stand

- (4) Rubber Leg Caps - RCR012500
- (4) Top Gussets - RFG010000
- (4) Mid-Gussets - RFG010001
- (4) Stand Braces - SXX000000
- (4) 35 Gal. Leg Set - SXX000035 or
- (4) 55 Gal. Leg Set - SXX000055

### Stand Hardware Kit - AHX000100

- (16) 1/4"-20 x 2" bolts
- (16) 1/4"-20 x 3/4" bolts
- (32) 1/4" flat washers
- (32) 1/4"-20 Nylock nuts

1. Motor Assembly - (2hp) BXI002105 / (2.5hp) BXI002505
  - 1a. 2hp motor - BMZ020105 / 2.5hp - BMZ025105
  - 1b. Magnetic Starter w/ Remote Option - AMR221114
  - 1c. Cord Connector - WCC025038
  - 1d. Cord Connector Lock Nut - WCN120000
  - 1e. Fan Wheel - BWX142578
  - 1f. Motor Plate - RMP002105
2. Fan Housing - BHX030005
3. Cyclone Barrel - SXI002105
4. Cyclone Cone - SCX002105 / SCX025105
5. Plenum 8" Kit - GXF015300
  - 5a. Plenum - FPX000001
  - 5b. J - Hooks (8) - AFJ051602 / AFT000001
  - 5c. Cartridge Filter Threaded Clamp (4) - AFX000000
  - 5d. Fender Washer (4) - AFW170000
  - 5e. Dust Bin - (13") FPZ000013 / (18") FPZ000018
- 5f. Hardware Kit - AHX000001
  - f1. (3) 3/8 x 1 1/4" Bolts - AFS015700
  - f2. (14) 3/8" Washers - AFW190000
  - f3. (7) 3/8" Wiz Nuts - AFT00004
  - f4. (4) 3/8" x 1" Bolts - AFS015100
  - f5. (12) 5/16" x 1" Bolts - AFB155190
  - f6. (40) 5/16" Washers - AFW180000
  - f7. (12) 5/16" Wiz Lock Nuts AFT155175
  - f8. Gasket - RGZ000000
  - f9. (16) Clips - AFT051618
  - f10. (16) Flange Bolts - AFB155155
- 5g. Internal Silencer - (2hp) BSC130000 / (2.5hp) BSC180000
- 5h. Owner's Manual - ZBM000013
- 5i. Filter Plate - (13") FPX010013 / (18") FPX010018
6. Filter - (2hp) FCS133995 / (2.5hp) FCS183900
7. Wall Bracket - SMS300021
8. Decal - (1) Oneida Logo - ZBC000015
9. Decal - (1) Gorilla Logo - ZBC990020
10. Rotation Label - ZBC000029
11. Caution / Exhaust Label - ZBS000004
12. General Caution Label - ZBS000001
13. Filter Maintenance Label - ZBS000007
14. Caution / Check Frequently Label - ZBS000006
15. Caution / Drum Cover Label - ZBS000005
16. Gal. Fiber Drum Kit (Standard) - SDK350901
  - 16a. Drum Lid w/ 9" Ring - SDX000900
  - 16b. Hose Clamp (2) - ACB120000
  - 16c. Flex Hose (9") - DHF090000
  - 16d. 35 Gal. Fiber Drum - SDS350000
17. 55 Gal. Fiber Drum Kit - SDK550901
  - 17a. Drum Lid w/ 9" Ring - SDX000900
  - 17b. Hose Clamps (2) - ACB120000
  - 17c. Flex Hose (9") - DHF090000
  - 17d. 55 Gal. Fiber Drum - SDS550000
18. 55 Gal. Steel Drum Kit - SEK550901
  - 18a. Drum Lid w/ 9" Ring - SEX550900
  - 18b. Hose Clamps (2) - ACB120000
  - 18c. Flex Hose (9") - DHF090000
  - 18d. 55 Gal. Steel Drum - SES550000

**Note: For cyclonic preseparation there must be an air tight seal between cyclone and dust container. Dust bin must be located vertically under cyclone, material drops down by gravity.**

# VI. Assembly Instructions

## Instructions for assembly of the Fan Blower Housing and Barrel of the Oneida Models.

1. Push clips onto inside circle on Fan Housing, making sure clip is pushed all of the way on, that the bolt holes are in alignment with the clip holes and that the small barrel on the clip is on the **INSIDE** of the Fan Housing as shown in diagram.
2. Stick the gasket material around the Fan Housing as shown in the diagrams, outside of the bolt circle. Making sure of a complete seal. Dust collection systems cannot operate effectively without being tightly sealed with no air leaks.
3. Put bolt through washer. then into appropriate bolt holes in Fan Housing and Barrel. Tighten bolts so they all are snug, then go back and finish tightening the bolts in a star pattern.

Proportions and sizes of parts may be exaggerated for purposes of explanation.

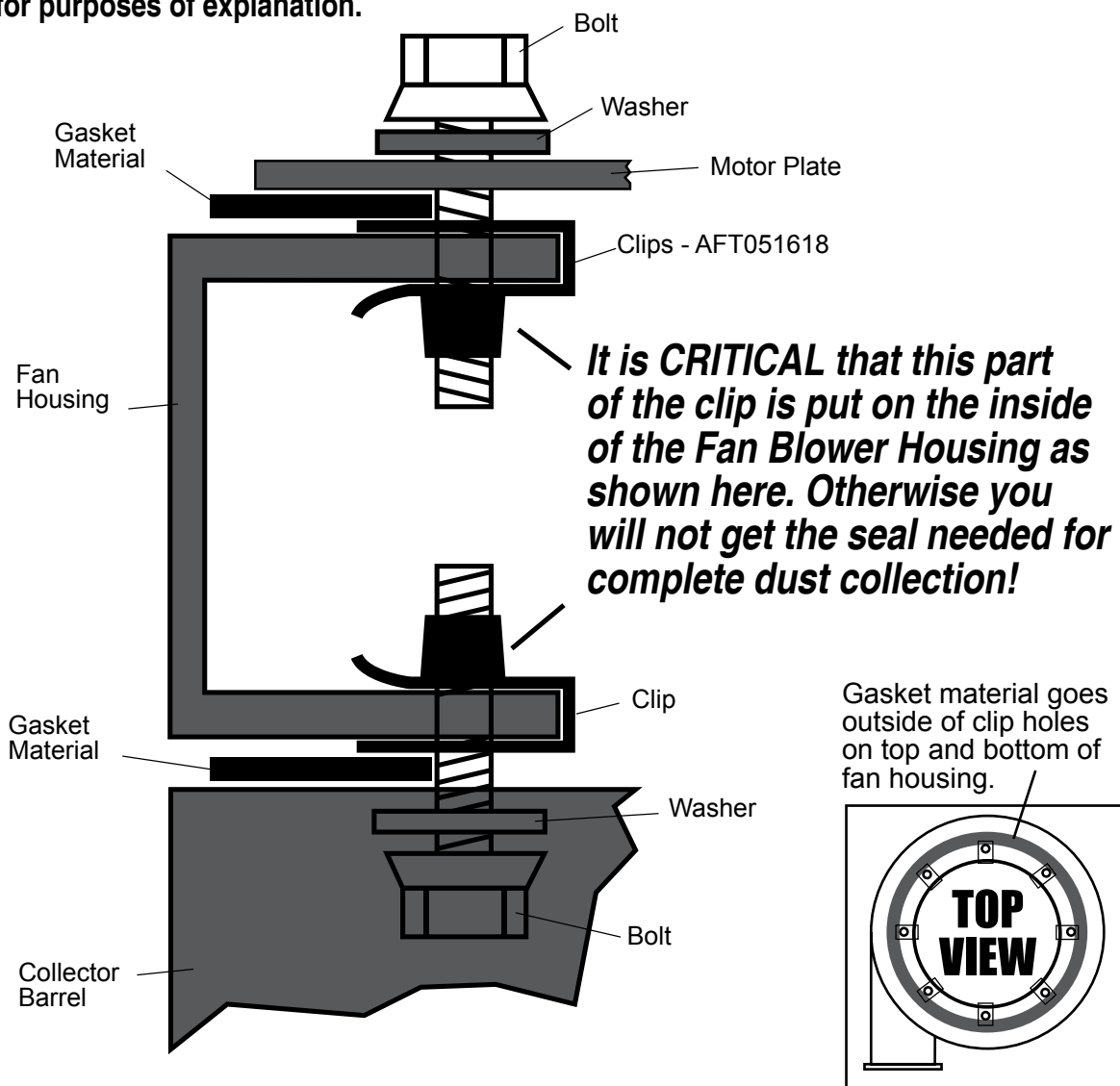



# VI. General Assembly Instructions

Do NOT use hook on motor to lift unit.

*There are essentially three ways to assemble your collector and to attach it to the stand. The way that is right for you should be determined by expertise and manpower available. When the units are all assembled they are very heavy and top weighted. All of this should be taken into account before deciding on the method best suited for you.*

*With all assemblies, make sure rectangular air outlet is oriented on Fan/Blower housing as you are looking down as in Fig. 1A or facing it as shown in diagrams. This is very important.*

Then you can rotate the housing to whatever bolt position is best for your shop.

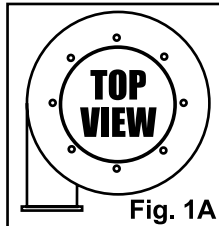

Before you start, make sure you have read the directions thoroughly.

## Method #1 -

Bolt Fan / Blower housing to Cyclone barrel, Then bolt Motor and Plate to Fan/Blower housing. Carefully lay unit on its side and then bolt cone to barrel. Lift entire unit up onto stand. Unit is extremely heavy and top weighted, be advised!

## Method #2 -

Bolt Fan / Blower housing to Cyclone barrel, Then bolt Motor and Plate to Fan/Blower housing. Put Cone up on stand and orient holes. Lift assembled unit onto cone making sure proper holes are lined up. Bolt unit to stand, then finish bolting barrel to cone.

## Method #3 -

Bolt Fan / Blower housing to Cyclone barrel, Put Cone up on stand and orient holes. Lift assembled unit onto cone making sure proper holes are lined up. Bolt unit to stand, then finish bolting barrel to cone. Lift Motor & Plate onto Fan/Blower housing and bolt together in proper direction.

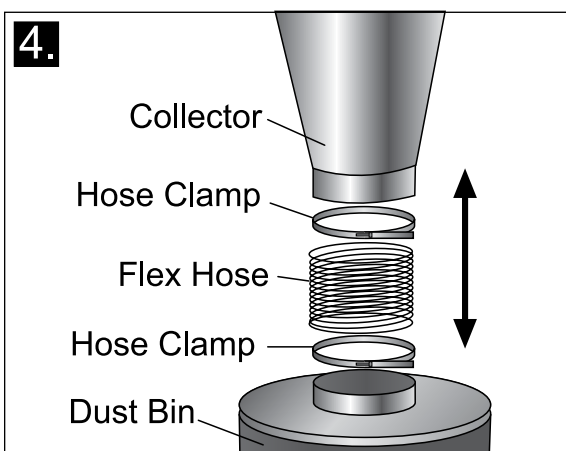

If you are having trouble getting your drum out to empty it, you can cut down the flex hose to give yourself more room. Just make sure that the drum lid tightly seals to the drum and that there are no leaks in the flex hose connection.

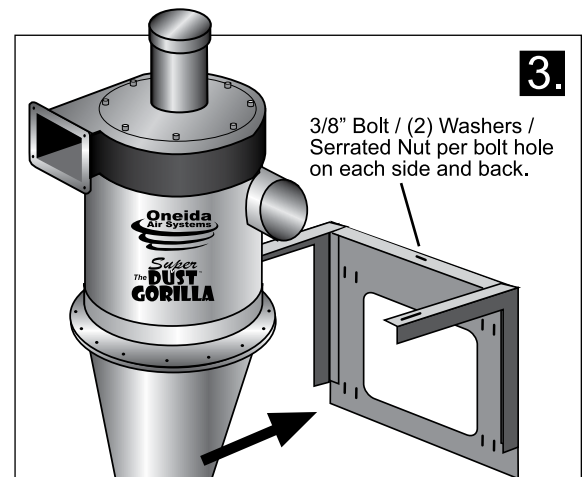
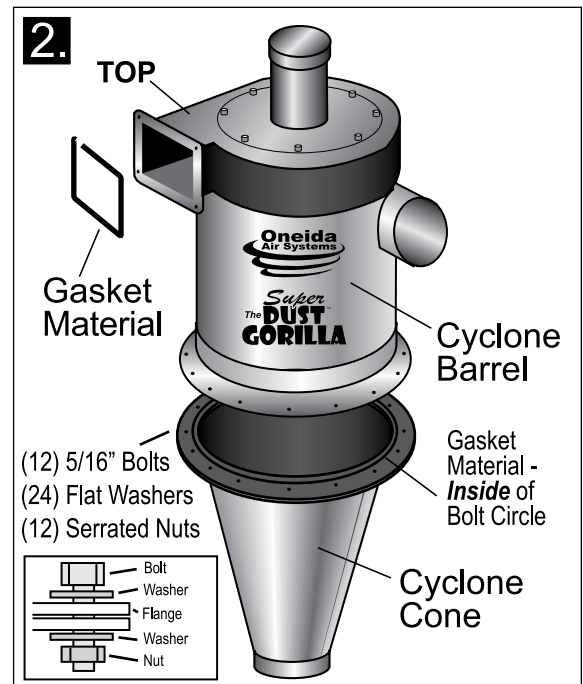
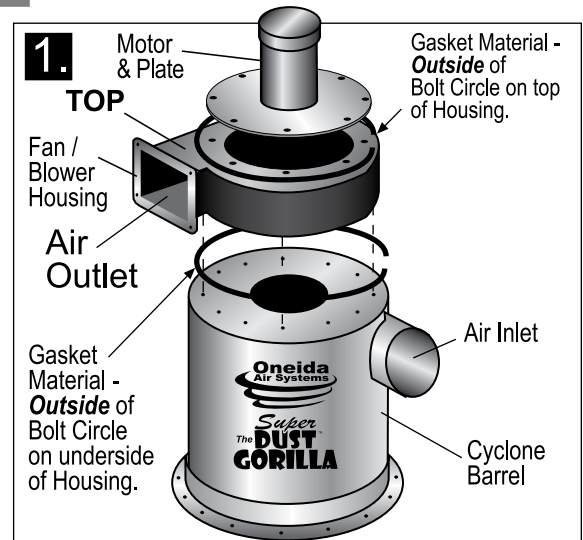

## VII. Bracket Assembly

1. You must determine the direction the fan outlet will point to proceed with this mounting assembly. The collector will seem quieter if the outlet is aimed away from the area people tend to work. Slots in the brackets are 1 cm x 2.54 cm.

Note: Bolts included to mount bracket to collector. Hardware NOT included to mount to wall.

2. Hold bracket against wall with top of plate at 142.2 cm. Mark where mounting holes fall. Mount wall bracket. For wall mounting, the bolt centers on the brackets are at 40.6 cm to accommodate most wall stud spacing. See Fig. 1 & 2. Use a Level to ensure straightness.

3. Attach bracket to wall with lag screws, concrete anchors, or other suitable hardware. See Fig. 2 & 3. Note: When installing the brackets on a concrete wall, mount 2 x 4's between wall and brackets to stabilize and dampen vibration.

4. Position Angle Ring around top of cone over bracket. Line up one hole in Ring with hole in each bracket at desired rotation of outlet. If rotation you desire does not correspond to an existing hole in Angle Ring, drill new ones. Use three 3/8" bolts (included) with washers & lock washers to secure the fan. See Fig. 4.

5. Attach tightly with bolts. See Fig. 4.

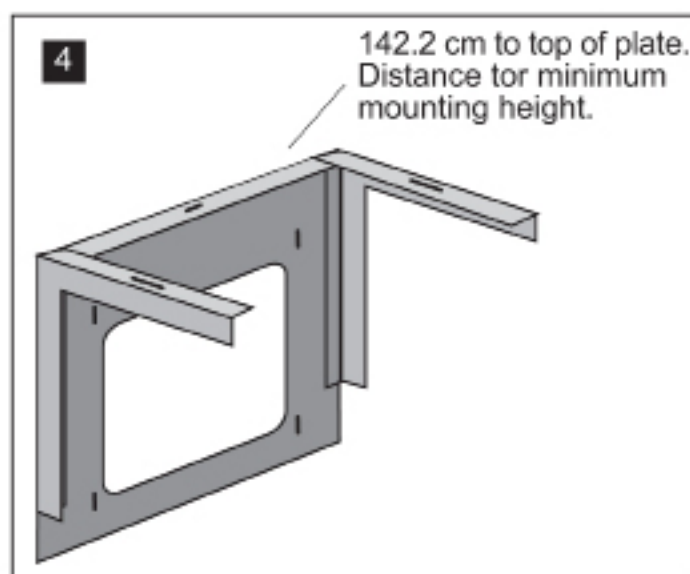
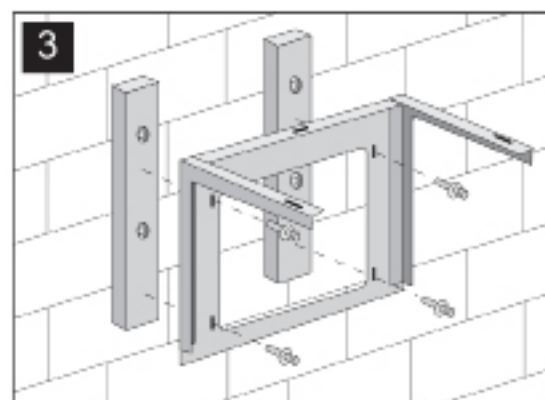
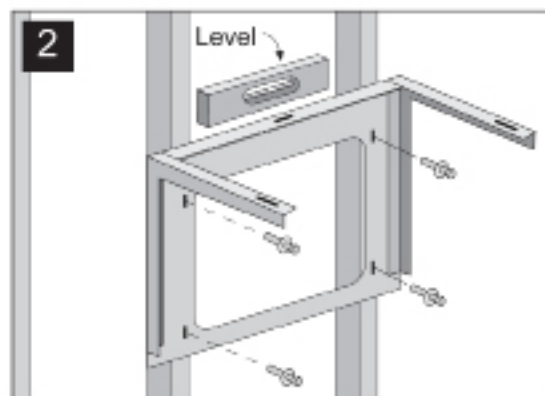
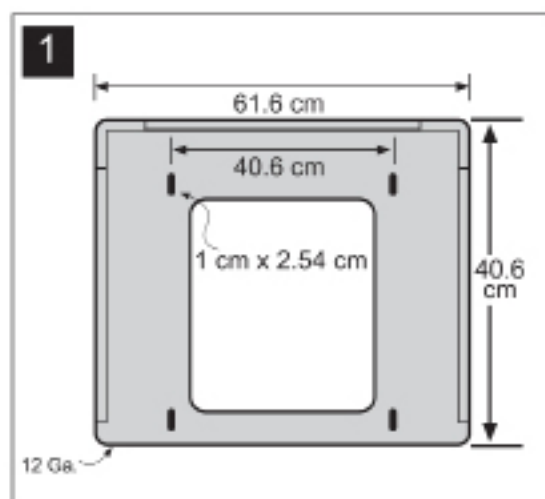

## VIII. Filter Assembly

### External 99 cm Filter Assembly \*Silencer Included

1. Attach gasket to collector outlet making sure there are no gaps where gasket ends meet.
  2. Attach Plenum to outlet using the included 7 bolts and hardware making sure the support hanger on the Plenum is at the bottom.
  3. Attach gasket around cut out in filter plate as shown in diagram, making sure there are no gaps where ends meet.
  4. Attach filter plate to Plenum using the 9 included elevator bolts, washers and nuts, putting them up through the plate and Plenum from underneath making sure the shaped bolt shaft is snug in the diamond hole in plate.
  5. Attach filter cartridge with provided J hooks making sure the gasket is sealed tightly and internal silencer is in
  6. If filter requires additional support, use the plate at the top of the filter to support the filter assembly or support hanger on Plenum.
- Note: If filter cartridge is located away from the cyclone and motor, additional square to round connectors and pipe can be purchased.
7. Attach the filter dust bin to the bottom of the filter with the J hooks making sure that the seal is tight.

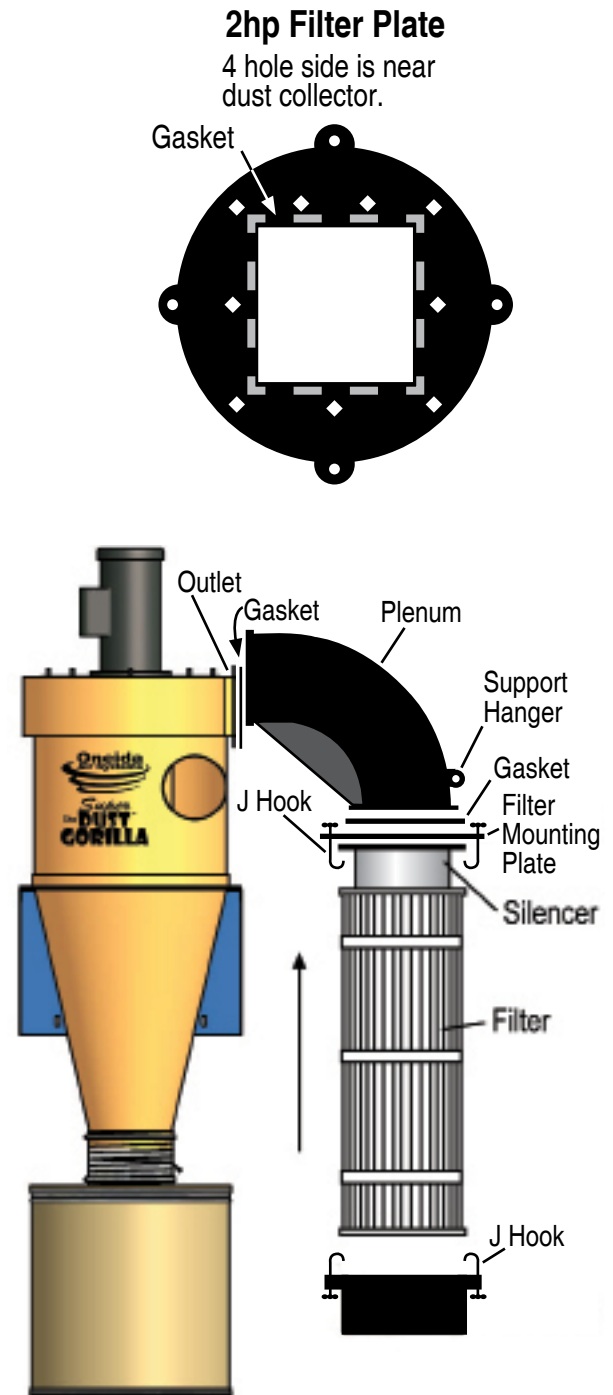

## IX. Filter Maintenance

### ***External Filter Cartridge Cleaning Intervals***

When unit is turned off, use compressed air to blow dust off from exterior of filter. Hold nozzle at least 6" away from filter pleats\*. Do not remove bottom dust pan before or during the blow-off process! Let dust settle into dust pan. Unclip and dump out dust. Filter removal is not required.

*\*WARNING: A close, direct blast with the compressed air nozzle too close to filter, may damage filter media. Always wear safety glasses while blowing off filter.*

***Caution: Fine dust collected in filter is hazardous to your health! Do not breathe!***



Shown with optional Stand.

### ***Fan / Blower & Cyclone Outside Placement***

Fan / Blower has a TEFC - Totally Enclosed Fan Cooled Motor.  
Note: Use steel drum when placed outside.

#### ***Caution:***

If exhaust air is vented outside you must provide make up / return air.  
Flue gases (carbon monoxide) can be drawn into the shop from furnaces, water heaters or other appliances.

### ***Before Operation:***

Mount system and connect cyclone and dust bin. Make sure dust bin is in place and ductwork is connected to inlet before turning on the dust collector.

***Do not operate Fan / Blower unless Cyclone and Dust Bin are in place! Motor will overheat!***

### ***Electrical Wiring:***

Make sure power source matches wire voltage configurations on motor.

Prior to connecting to the power line, check motor plate for proper voltage. Motor is pre-wired for counter-clockwise rotation. Fan wheel must rotate counter-clockwise if looking down on fan housing. Use 12 gauge cord for the fan / blowers.

### ***Lubrication:***

See pg. 19 for schedule and specifications.

***Caution: Rotating Fan Blades! Keep objects clear of outlet.***

## X. Directions for Cleaning External Filter

All steps should be done with a dust mask and eye protection. Proper filter cleaning should not be neglected. A dirty filter can affect dust collector operation and filter life.

### 1. *Compressed air from outside.*

Blast air along pleats of the filter at about a 20 degree angle. Blast air out and away from you or anyone in the general area.

Keep air nozzle at least 6" from filter. Closer blasts may damage material. This operation should be done with filter on the unit. Dust is trapped inside filter so it will not make a mess.

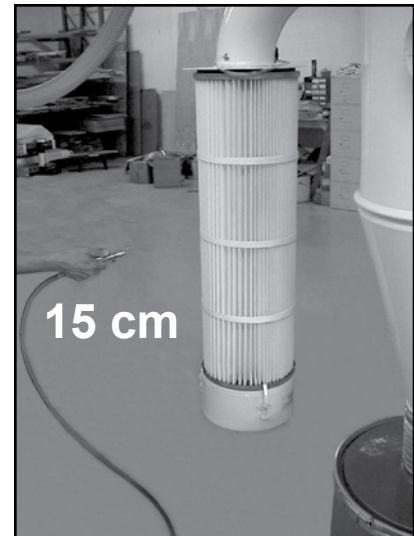

### 2. *Empty Dust Bin.*

Wait a few minutes for internal dust to settle then unscrew thumb nuts from J-Hooks and remove dust bin. Empty dust carefully. Replace dust bin. Do not over tighten thumb nuts.

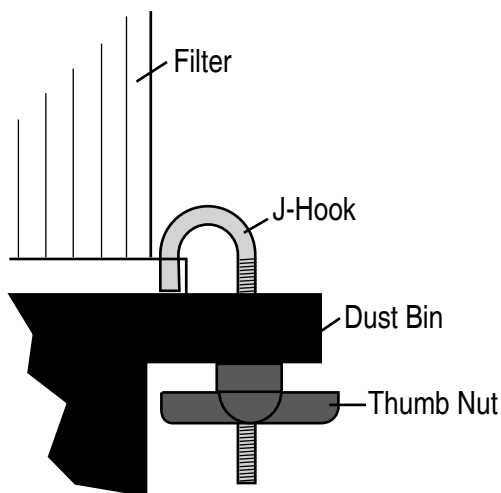

### **If you have the Filter Efficiency Gauge.**

Filter must be cleaned regularly or filter damage may result. If gauge reaches 3, it is time to clean your filter. Never allow gauge to reach 5. You could destroy your filter. See page 21.



# XL Wiring Diagram for Magnetic Starter (220v, 1Ø\*\*)\*

*Always use a licensed, professional electrician.*

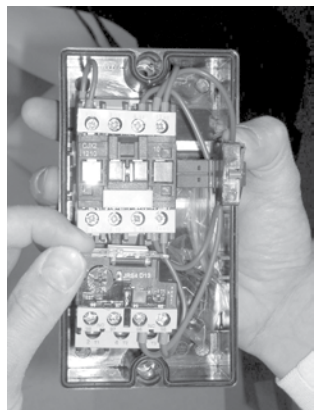
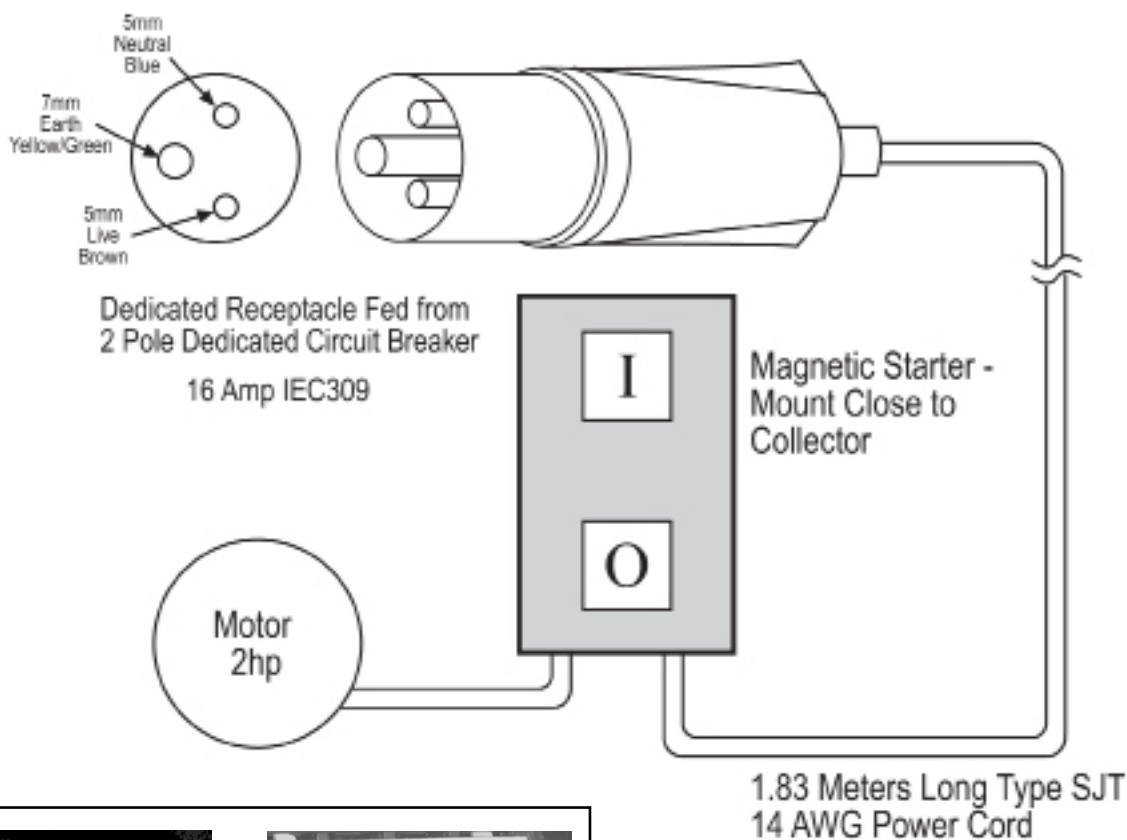

Open access cover on the Overload.

**Note: Overload must be set or nuisance tripping may occur.**

\*SFA - Service Factor Amperage  
\*FLA - Full Load Amperage

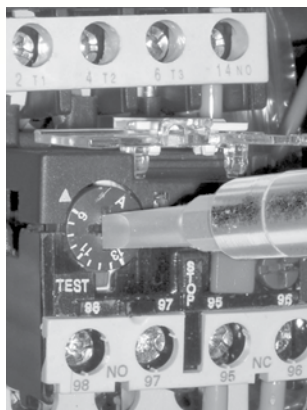

Set the overload amperage dial for the SFA\* amperage of your motor. The SFA\* value can be found below:  
SFA = 12.1  
(FLA  $\pm$  11.5)

**\*Starter will not operate at any other voltages.  
\*Starter is shown configured for 1Ø.**

## XII. Troubleshooting

### **Motor Overheating**

*The motor's internal circuit breaker will trip if the motor is overheating.*

Motor amperage too high - Shut system down.

Caused By:

- System should be completely bolted and sealed together.
- Ductwork should be completely installed and sealed with sealant.
- Air leaks between the collector and dust bin.
  - The lid of the dust bin and the cyclone must be in place and sealed when operating the dust collector.
  - Make sure flex hose is not torn and the hose clamps are tight.
  - Check drum lid; cover should have a foam seal and be well seated.
  - Check for holes or leaks in the dust bin barrel.
- Motor not properly wired. Check wire connections.
  - Check motor rotation - See wire diagram
- Check breaker box. Make sure incoming power supply matches motor specifications.

**Note:** If you continue to experience difficulty with your collector, call Oneida Air Systems at 1.800.732.4065 for assistance.

### **Poor Dust Pick-Up at Woodworking Machines**

Caused By:

***Improper motor rotation - Running backwards will reduce suction by 30%.***

- Check length of duct runs and duct diameters compared to ductwork design guideline.
- Make sure all ductwork is sealed. Large air losses will occur even through small cracks in the ductwork. Use silicone, duct tape or duct mastic compound as a sealant.
- Check for air leaks between collector and dust bin.
- Close all unused blast gates at your woodworking machines.
- Examine hood design for weaknesses according to the ductwork guide.
- Check for a restricted pipe, too small a hood port or too small a branch line. See branch line diameter chart in ductwork guide.
- Be sure that your filter is clean. See filter cleaning directions.

### **Filter Clogging**

Caused By:

- Air leakage between cyclone and dust bin. Cyclone and dust bin must be air tight. Even small leaks can will cause poor pre-separation in the cyclone.
- Large chips clogging the filter:
  - Check for a leak in the dust bin, flex coupling or lid. Check for split or torn flex coupling. (See also: Motor Overheating Section above.)
  - Make sure dust bin has not over filled. Dust bin should be emptied before dust reaches top of container.
  - Interruption of air flow, such as vacuuming chips with a flex hose connection, will increase filter maintenance.
  - Minimum 4" diameter pick up at tool location. Less than 4" will restrict air flow into collector and will increase filter maintenance, If there is not enough air entry in system, open more blast gates.
  - Make sure clamp around cyclone is tight and sealed with silicone.

### **Excessive Vibration**

Caused By:

- Loose mounting bolts.
- Excessive system pressure or restriction of air due to closed blast gates.
- Accumulation of foreign material on the fan wheel.
- Inadequate support structure.



# **XIII. Fire Hazards - Read Before Installing and Operating**

## ***Oneida Collectors are designed for WOOD DUST only!!***

Wood shaping and cutting processes generate wood chips, shavings, and dust. These materials are considered combustible. Air borne wood dust below 420 microns in size (.017 of an inch) in certain concentration ranges when ignited can deflagrate (burn quickly).

An ignition source such as a spark or ember can ignite a dust mixture resulting in an expanding flame front which can cause an explosion if tightly contained. A disturbance that raises a cloud of accumulated fine dust can raise additional dust clouds, which can cause a series of explosions that can level an entire building. *Until this type of fire has been witnessed, it is difficult to believe the devastation. This type of fire is rare but worth safeguarding against.*

The best way to avoid a wood shop fire is to keep the shop clean. A shop ankle deep in dust with layers of fine dust everywhere is an accident waiting to happen. A good dust collection system reduces overall fire hazards but also adds new concerns. A fire hazard is still present. Combustible material is now in the dust collector and storage container.

The following points are worth heeding:

- It is the buyer's responsibility to follow all applicable federal, state, local, OSHA, NFPA, or authorities having jurisdiction codes and regulations when installing and operating this dust collector.
- Fire marshals may want the unit located outside of the building. If the collector is located inside the facility, controls such as spark detection, suppression, or explosion venting may be required.
- Most local jurisdictions consult or adopt NFPA (National Fire Protection Agency) codes. However, other codes may apply. Local codes may vary from jurisdiction to jurisdiction.
- NFPA 664 Code book, "Standard for the Prevention of Fires and Explosions in Wood Processing and Woodworking Facilities", applies to woodworking operations that occupy areas of more than 5,000 sq. ft. or to areas where dust producing equipment requires an aggregate dust collection flow rate of more than 1500 cfm (cubic feet per minute). This exempts some small operators from the NFPA code 664, but other codes may apply in your jurisdiction. Consult your local Fire Marshall for help. Additional information can be found in NFPA Code Book 664.

*The customer assumes the responsibility for contacting their insurance underwriter with regard to specific application requirements of explosion venting or if additional fire protection and safety equipment may be required.*

**Do not use this product to collect other types of dust or flammable vapors.**

### **Fire or explosion may occur!**

- Never collect sparks from a bench grinder into a wood dust collector.
- Never introduce sparks or sources of ignition into the dust collector.
- Personnel should keep at least 20 feet away from unit.
- Check dust bin frequently and before leaving the shop for smoldering material.

Keep portable Fire Extinguishers handy.

- The ABC type (dry chemical) is generally a good choice for small wood shops. Additional information on portable extinguishers can be found in NFPA 10 (Standards for Portable Fire Extinguishers).
- Be especially careful with sanding units. They can produce concentrations of dust in the combustible range. Make certain enough air volume is at the suction point to capture all the particulate generated.
- This high air volume will dilute the mixture below the lower limit of flammability. Be careful not to generate sparks into the sanding dust.
- Empty dust bin and clean filter often, especially when sanding.
- Don't overload woodworking equipment, especially sanders. Excessive frictional heat can spontaneously ignite dust.

Sparks can be generated in several ways:

- High-speed sanders and abrasive planers may strike foreign material.
- Saws and edgers may strike foreign material and create a red hot metal fragment.
- Knots in hardwood can create frictional sparks.
- Tramp metal when drawn into the collector can spark against ductwork.
- Check wood stock for old nails and screws which can create red hot metal fragments.
- Avoid using excessively large wood waste storage bins.
- Always check storage bins for smoldering material before leaving for the day.
- Electrically ground all equipment and ducting. Static sparks can ignite wood dust. (Avoid using PVC drainpipe).
- Don't allow accumulation of layers of fine dust on horizontal surfaces. (Especially overhead lights, electrical boxes, and fuse panels which can ignite dust).

# **XIV. Terms and Conditions**

---

## **Checking in Order**

Please look over the shipped order very carefully in the presence of the delivery person for damage or incomplete shipment before signing the delivery receipt. Please note any tears or irregularities in shipping packaging, however slight, on the shipping delivery receipt. This could be an indication of extensive concealed damage. The shipping company will not take responsibility if the damage is not noted on the delivery receipt. In the event of shipping damage, call O.A.S. immediately so we can expedite replacements. Please check in all parts within 3 days from receiving order. Notify O.A.S. immediately of any missing or incorrect parts. O.A.S. does not accept any claims for damage or shortage after 3 days from date of delivery.

## **Limited Warranty**

Oneida Air Systems warrants products it manufactures for a period of 2 years to the original purchaser from the date of purchase. Items not manufactured by O.A.S. are limited to their own manufacturer's warranties. All electrical items such as magnetic starters, remotes, sensors, pumps and accessories are limited to 90 days. This warranty does not apply to defects directly or indirectly to misuse, negligence, accidents, abuse, repairs, or alterations or lack of maintenance. This is Oneida Air Systems sole written warranty and any warranties that may be implied by law, including any merchantability or fitness, for any particular purpose, are hereby limited to the duration of this written warranty. O.A.S. does not warrant or represent that the merchandise complies with the provisions of any law or acts unless the manufacturer so warrants. In no event shall O.A.S.'s liability under this warranty exceed the purchase price paid for the product and any legal actions brought against Oneida Air Systems shall be tried in the State of New York, County of Onondaga.

Oneida Air Systems shall in no event be liable for death, injuries to persons or property or for incidental, contingent, special, or consequential damages arising from the use of our product.

Oneida Air Systems does not warrant or authorize use of wood dust collectors for other purposes. This includes wood products that are treated, coated, or otherwise altered from their natural state.

***\*Note: Motors should be protected from extreme weather to prolong motor life. Single phase motors should only be started and stopped up to 4 - 10 times per hour. Starting single phase motors more frequently can cause heat build up and can cause the motor overload to trip or cause motor damage. In general, motors should be started and stopped as little as possible for maximum lifespan and best economy (electrical use).***

## **Delivery Risk of Loss**

Products will be shipped to Buyer's single destination. Title and risk of loss shall pass to the Buyer upon delivery to such destination. Buyer pays transportation expenses. Dates of shipment are advisory and O.A.S. will make reasonable efforts to ship on or before the date states for shipment, however, O.A.S. shall not incur any liability for failure to ship on that date.

## **Returned Goods Policy**

Buyer must inform O.A.S. of any shortage or damage, by so noting in writing, on the freight delivery bill prior to signing to indicate receipt of shipment. All claims, including claims covered under the limited warranty, are subject to inspection and investigation by O.A.S. O.A.S. reserves the right to inspect, investigate all returned products before Buyer's claim is settled. All products returned for a cash refund must be unused, resaleable and purchased within 30 days. There are no refunds on flex hose, custom made components or partial kit items. Kits must be returned in full (all components) for credit. ***There will be a 25% restocking fee applied to any returned items. Buyer must call and get an RMA (Return Authorization Number). Merchandise must be shipped to us prepaid.***

***Installing a dust collection system will greatly reduce airborne dust levels in your shop. However, NIOSH recommends that respirators must be worn if the ambient concentration of wood dust exceeds the prescribed exposure limit. If in doubt wear a NIOSH mask.***

# XV. Stand Assembly

## 35 & 55 Gal. Stand - STG000035 / STG000055

### Stand Kit Contents



Hardware Kit (1) - AHX000100



Rubber Leg Cap (4) - RCR012500



Top Gusset (4) - RFG010000



Mid-Gusset (4) - RFG010001



Stand Brace 21" - 23" (4) - RFG010002



Stand Leg Set 35 Gal. (4) - SXX000035  
Stand Leg Set 55 Gal. (4) - SXX000055

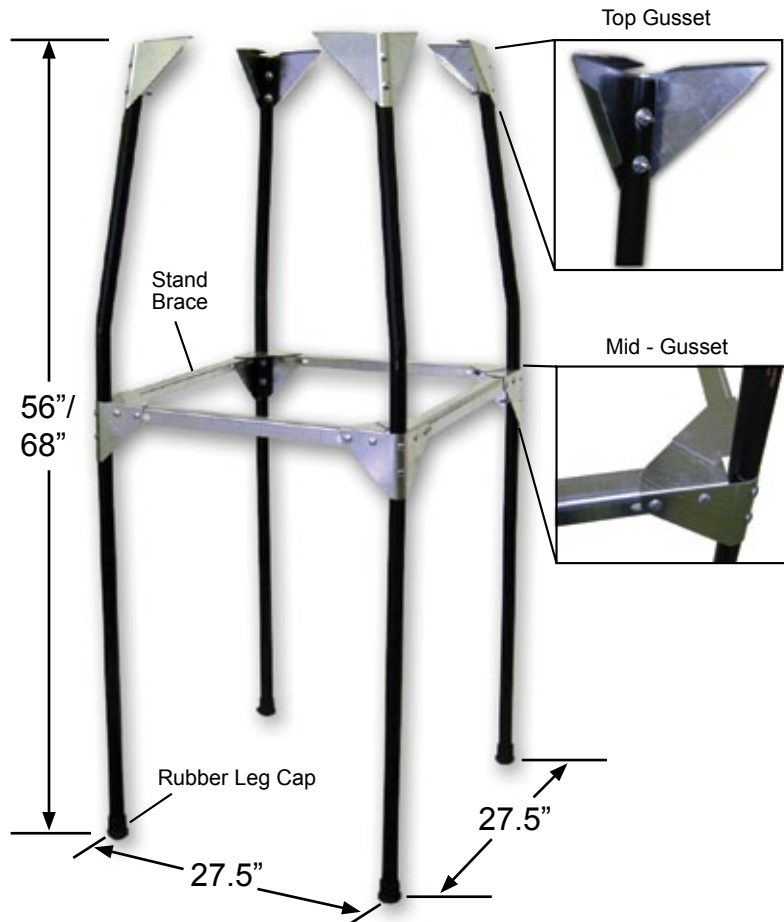

1. Attach Top Gusset to the top of leg as shown in photo with (2) 1/4"-20 x 2" bolts. Then secure with 1/4" Flat Washer and 1/4"- 20 Nylock Nut. Attach Mid-Gusset to middle of leg as shown with (2) 1/4"-20 x 2" bolts and secure with 1/4" Flat Washer and 1/4"- 20 Nylock Nut. Put Rubber Leg Cap on bottom of leg. Repeat on other three legs.

2. Attach Stand Braces to the inside of Mid-Gussets with (2) 1/4"- 20 x 3/4" bolts and secure with 1/4" Flat Washer and 1/4"- 20 Nylock Nut. Adjust the legs for the 21" or 23" cone by positioning the bolts in the appropriate position in the slotted brace hole. After assembly, make sure your Dust drum slides between the legs for easy emptying.

3. You may want to put the stand on it's side when you attach the collector cone and barrel. ***Always have appropriate help when lifting or moving the stand and collector. The unit is heavy!***

4. Bottom of Cone and Barrel rim go on top of stand gussets. Use the included cyclone hardware to attach to stand. Use (2) 5/16" x 1" bolts, (2) 5/16" flat washers and (2) 5/16" whiz nuts on each gusset.

## XVI. Accessories

### ***Bolt Together Stand***

STG000035 - 35 Gal. Stand

STG000055 - 55 Gal. Stand



### ***Replacement Filter***

FCS133900 (2hp) / FCS183900 (2.5hp)

13"x 39" / 95 Sq. Ft. Spun-Bonded. Filters 99.9% of test material from 0.2 - 2 microns.

18"x 39" / 110 Sq. Ft. Spun-Bonded. Filters 99.9% of test material from 0.2 - 2 microns.



### ***Filter Efficiency Gauge***

FXK000000

This easy to read gauge takes the guesswork out of knowing when your filters need to be cleaned and tells you how much pressure is backed up behind your filters. It reads pressure from plenum to gauge up to 8' away and allows you to keep your dust collection system running efficiently.

#### **Kit Contents:**



Gauge

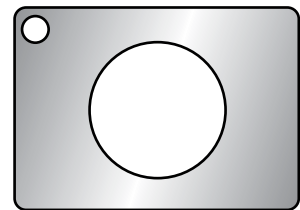

Bracket

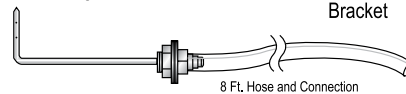

8 Ft. Hose and Connection

### ***Dust Containers***

35 Gal. Fiber

55 Gal. Fiber

55 Gal. Steel



### ***The BAG Gripper™***

ABX000000

The BAG Gripper provides the ability to use convenient plastic bags inside your dust drum. It provides a Constant negative pressure on the outside surface of the plastic bag that keeps it pulled tight against the sides of the dust drum. Can be used with 35 and 55 gal. barrels. Must be wired into your system.



# XVII. Fan Motor Maintenance

Per Baldor specifications, their 2 pole motors (3600 RPM) motors are to be relubricated **every 5500 hours**.

**Table 1 - Service Conditions**

| Severity of Service | Ambient Temperature Maximum   | Atmospheric Contamination             | Type of Bearing          |
|---------------------|-------------------------------|---------------------------------------|--------------------------|
| Standard            | 40° C                         | Clean, Little Corrosion               | Deep Groove Ball Bearing |
| Severe              | 50° C                         | Moderate dirt, Corrosion              | Ball Thrust, Roller      |
| Extreme             | >50° C* or Class H Insulation | Severe dirt, Abrasive dust, Corrosion | All Bearings             |
| Low Temperature     | <-30° C**                     |                                       |                          |

\* Special high temperature grease is recommended.

\*\* Special low temperature grease is recommended.

**Table 2 - Lubrication Interval Multiplier**

| Severity of Service | Multiplier |
|---------------------|------------|
| Standard            | 1.0        |
| Severe              | 0.5        |
| Extreme             | 0.1        |
| Low Temperature     | 1.0        |

Per Baldor specifications, add .30 ounces (8.4 grams) of Mobil Polyrex grease by weight or .6 cubic inches (2 teaspoons) of Mobil Polyrex grease by volume.

## Procedure

Clean the grease fitting (or area around grease hole, if equipped with slotted grease screws). If motor has a purge plug, remove it. Motors can be regreased while stopped (at less than 80° C) or running. Apply grease gun to fitting (or grease hole). Too much grease or injecting grease too quickly can cause premature bearing failure. Slowly apply the recommended amount of grease, taking 1 minute or so to apply. Operate motor for 20 minutes, reinstall purge plug if previously removed. Caution: Keep grease clean. Mixing dissimilar grease is not recommended.

# XVIII. Optional Remote Controller Diagram

## Applies If You Have the Remote Controller

Type: MS1 MS1-XXD 1 (3) X7 NXX XP-RW

Voltage: AC100 - 120v / 50-60 Hz and AC220 - 240v / 50-60 Hz (or appoint other voltage)

Frequency: 303.9 MHz

Temperature: -5 C to 60 C

Action Mode: ON Blue - Motor Start / OFF Red - Motor Stop

### Remote Controller Diagram

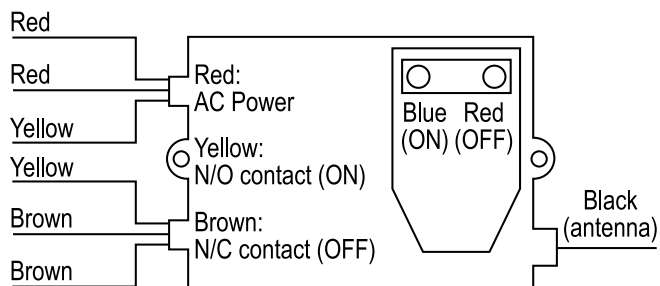

### Motor Start & Remote Controller Diagram

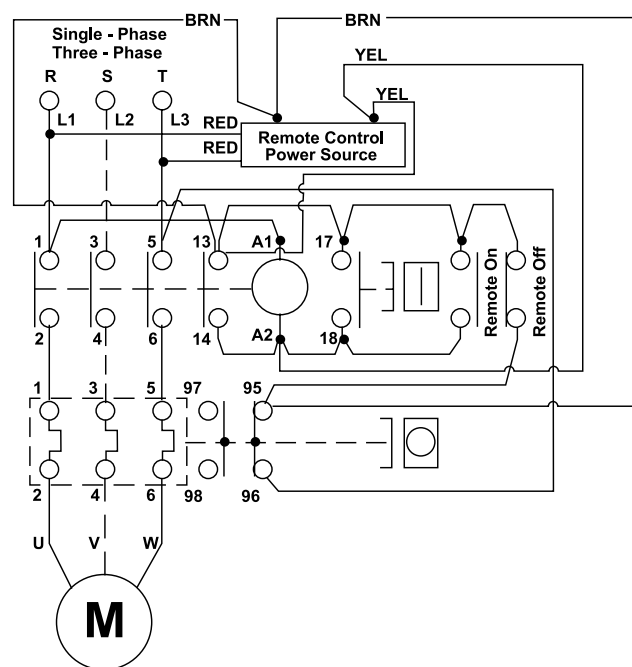

This device complies with Part 15 of the FCC rules. Operation is subject to the following two conditions: 1) This device may not cause harmful interference and 2) this device must accept any interference received, including interference that may cause undesired operation.

Notice: The changes or modifications not expressly approved by the party responsible for compliance could void the user's authority to operate the equipment.

**Important Note:** To comply with the FCC RF exposure compliance requirements, no change to the antenna or the device is permitted. Any change to the antenna or the device could result in the device exceeding the RF exposure requirements and void user's authority to operate the device.